

Wire Rope Sheave

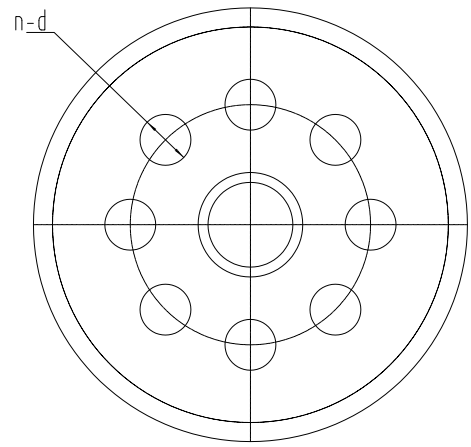
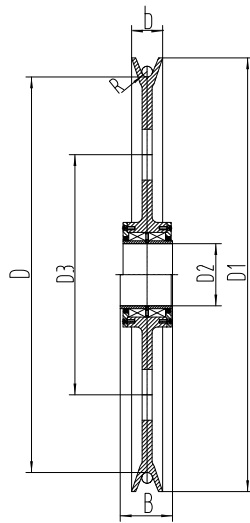

sheave type	main size					steel wire rope $\Phi\Phi$ (MM)	bearing type	weight (KG)
	ΦD	$\Phi D1$	$\Phi D2$	R	B			
HL315.1	315	350	40	6.5	60	8~12	6208	12
HL315.2			50		64		6210	13
HL315.3		360	60	8	68	12~14	6212	14
HL315.4			70		72		6214	16
HL400.1	400	450	60	8	68	12~14	6212	21
HL400.2			70		72		6214	23
HL400.3		460	80	10	76	14~18	6216	28
HL400.4			120		104		42224	44
HL500.1	500	550	80	10	76	14~18	6216	38
HL500.2			120		104		42224	45
HL500.3		570	100	12.5	92	16~24	6220	47
HL500.4			160		120		42232	79
HL630.1	630	700	100	12.5	92	16~24	6220	68
HL630.2			160		120		42232	100
HL630.3		720	120	16	104	20~30	42224	81
HL630.4			180		128		42236	119
HL710.1	710	780	100	12.5	92	16~24	6220	87
HL710.2			160		120		42232	118
HL710.3		800	120	16	104	20~30	42224	100
HL710.4			180		128		42236	138
HL710.5		820	140	20	108	26~38	42228	124
HL710.6			200		140		42240	180
HL800.1	800	890	120	16	104	20~30	42224	128
HL800.2			180		128		42236	164
HL800.3		910	140	20	108	26~38	42228	144
HL800.4			200		140		42240	200
HL800.5		940	220	25	154	32~48	42244	244
HL800.6			240		168		42248	291
HL800.7		980	240	29	168	44~54	42248	308
HL800.8			260		146		2097952	227
HL900.1	900	990	120	16	104	20~30	42224	163
HL900.2			180		128		42236	205
HL900.3		1010	140	20	108	26~38	42228	180
HL900.4			200		140		42240	235
HL900.5		1040	220	25	154	32~48	42244	281
HL900.6			240		168		42248	327
HL900.7		1080	240	29	168	44~54	42248	349
HL900.8			260		146		2097952	269
HL1000.1	1000	1110	140	20	108	26~38	42228	210
HL1000.2			200		140		42240	263
HL1000.3		1140	220	25	154	32~48	42244	325
HL1000.4			240		168		42248	370
HL1000.5		1180	240	29	168	44~54	42248	383
HL1000.6			260		146		2097952	304
HL1120.1	1120	1230	140	20	108	26~38	42228	258
HL1120.2			200		140		42240	313
HL1120.3		1260	220	25	154	32~48	42244	362
HL1120.4			240		168		42248	416
HL1120.5		1300	240	29	168	44~54	42248	430
HL1120.6			260		146		2097952	373
HL1250.1	1250	1390	220	25	154	32~48	42244	426
HL1250.2			240		168		42248	474
HL1250.3		1420	240	29	168	44~54	42248	493
HL1250.4			260		146		2097952	412
HL1400.1	1400	1540	220	25	154	32~48	42244	518
HL1400.2			240		168		42248	562
HL1400.3		1570	240	29	168	44~54	42248	593
HL1400.4			260		146		2097952	484