

## Conjoined with gear wheel

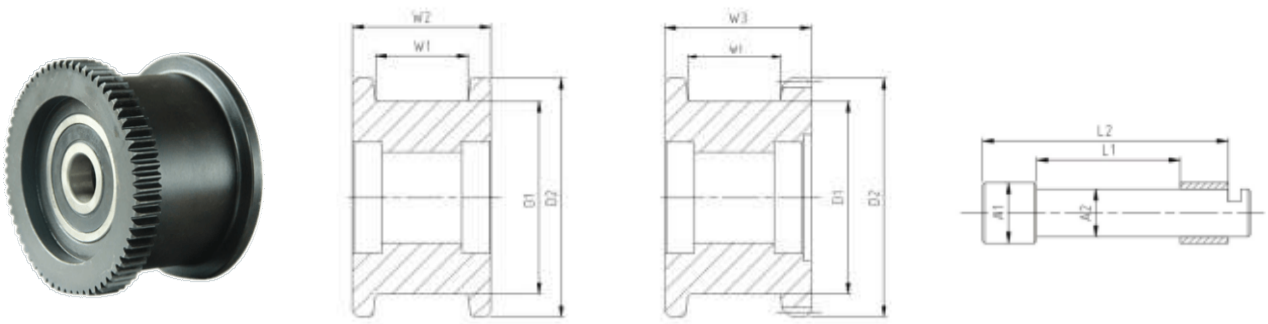

Model	D1	D2	W1	W2	W3	L1	L2	A1	A2	Load KN
W125	125	155	60	90	95	90	154	38	30	50
W160	160	190	70	100	105	100	154	58	50	100
W200	200	230	70	100	105	100	154	58	50	180
W250	250	280	80	110	115	110	204	68	60	250
W315	315	355	90	120	125	120	204	78	70	350

## DIN15900 toothed wheel

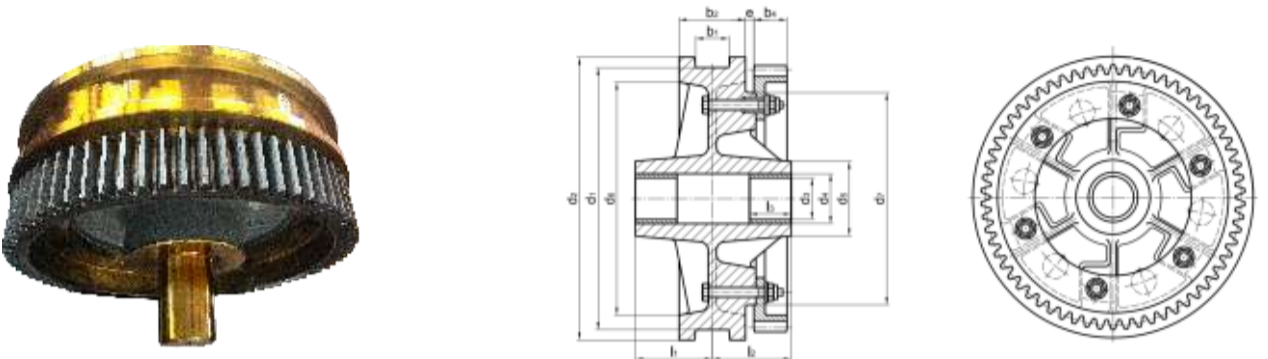

Model	d1	d2	d3	d4	d5	d6	d7	b1	b2	l1	l2	l3	e	b4	
200	200	230	45	55	85	170	160	40-55	90	105	105	45	15	40	
250	250	280	50	60	100	210	200	40-55	90	115	115	50	15	50	
315	315	350	60	75	120	270	260	45-55	90	125	125	63	15	60	
								55-65	110	135	135				
400	400	440	80	95	140	345	345	270	55-65	110	140	140	80	15	65
								300	70-90	140	155	155			
								270							
								300							
500	500	540	90	105	160	435	435	350	55-65	110	145	145	90	15	70
								390	70-90	140	160	160			
								350							
								390							
630	630	680	100	120	180	560	560	460	65-75	120	165	165	100	20	80
								510	80-110	160	185	185			
								460							
								510							
710	710	760	110	130	200	630	630	510	75-90	140	185	185	110	20	90
								580	95-160	210	220	220			
								510							
								580							
800	800	850	125	145	220	710	710	610	75-90	140	195	195	125	20	100
								660	95-160	210	230	230			
								610							
								660							
900	900	950	140	160	240	805	805	680	75-90	140	205	205	150	20	110
								750	95-160	210	240	240			
								680							
								750							
1000	1000	1050	160	180	270	900	900	790	75-90	140	205	205	150	20	110
								840	95-160	210	240	240			
								790							
								840							

## Hoist trolley wheel

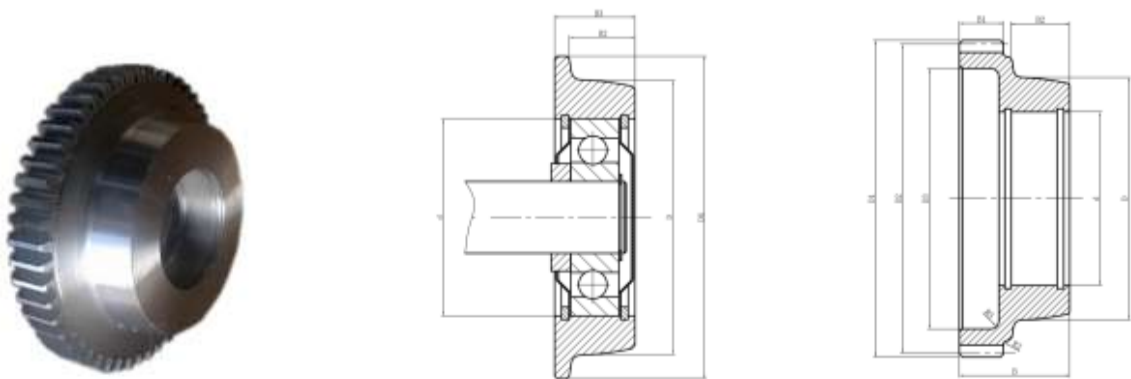

Wheel	D	D1	D2	D3	D4	B	B1	B2	B3	d	gear		unit weight	
											M	Z	driving	passive
83	83				100			20	25	62	3	53		0.55
113.5	113.5	162.6	159	137	130	50	20	26	30	62	3	53	2.1	1
134	134	180.6	177	155	155	57	22	30	40	100	3	59	2.95	2.2
154	134	200.8	196	165	180	70	28	37	45	110	4	49	4.5	3.45